

# Touch the future today



X·smart **iQ**<sup>TM</sup>

REDEFINING THE ENDO EXPERIENCE

**DENTSPLY**

Small things. Big difference

THE MAKERS OF

PROTAPER® | CAVITRON® | WAVEONE® | SDR® | CERAM.X® | NUPRO®

# COMPLETE FREEDOM OF MOVEMENT

A **slim, well-balanced** and **cordless** handpiece



**Easy access** and **excellent visibility**

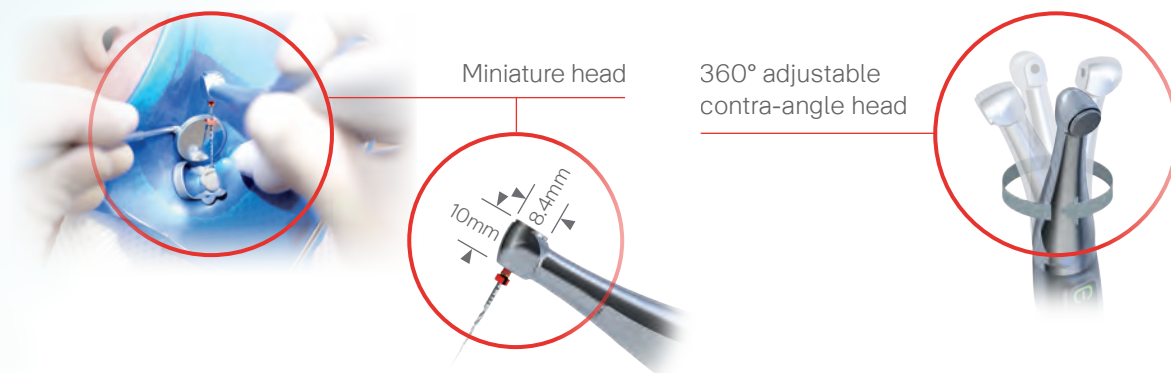

Quickly switch from **reciprocating** to **continuous** motion

wave•one<sup>®</sup>  
GOLD

## Reciprocating

The latest reciprocating technology to shape the canal with confidence



PROTAPER•NEXT<sup>®</sup>

## Continuous

The next generation of the world's leading NiTi system for performance and versatility

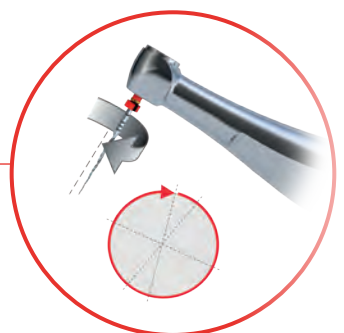

\*A treatment is defined as 2 canals with 4 files per canal used for 30s each

# POWERFUL CAPABILITIES OF AN iOS® APP

## Set the **right expectation**

Using the set of simple images already stored in the DENTSPLY iQ application, explain the endodontic treatment to your patient.



## Flow through your **sequence** with **peace of mind**

Select a DENTSPLY MAILLEFER file sequence

or

Easily create your own file sequence



## Feel safe

Instant torque level indication: visual and audible sound

Auto-reverse function available in continuous and reciprocating motion



Calibration function (CAL) for more precise torque setting



Graph showing real-time torque applied to each file over time

Auto-power off for energy saving



WITH RTTM TECHNOLOGY  
• (Real-Time Torque Monitoring)

## Facilitate **treatment data capture** and **transfer**

- Associate basic treatment notes (tooth number, working length, last file used, obturation, notes) to a specific patient
- Transfer your treatment report to your patient file

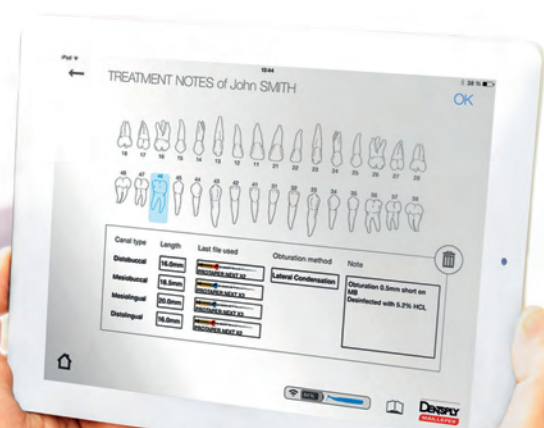



TOUCH  
SCREEN



HYGIENIC  
BARRIER



WATER-RESISTANT



EASY  
TO DISINFECT



FLEXIBLE  
IPAD PROTECTIVE  
CASE

AN iPad Mini™ PROTECTIVE CASE DESIGNED  
FOR YOUR DEMANDING ENVIRONMENT

# SEAMLESSLY CONNECTED

x smart iQ™ is a **continuous** and **reciprocating** motion **cordless** motor controlled by an Apple iOS® application developed by DENTSPLY MAILLEFER.

It is a **complete solution** designed to:

- Give you **more freedom** when shaping
- **Support you** throughout the endodontic treatment
- **Prepare your practice** for the future



x smart iQ™

REDEFINING THE ENDO EXPERIENCE

- Complete freedom
- Endo partner
- Future proof

Watch the video: [www.dentsply.co.uk/iq](http://www.dentsply.co.uk/iq)

# TECHNICAL SPECIFICATIONS

## MOTOR and CONTRA-ANGLE

### Bluetooth® memory function

If the Bluetooth® connection is lost, the X-SMART iQ motor can still function under the last motor settings used

### Stand-alone function

Using the application, the motor can be set to run solely with reciprocating or continuous\* settings without the iPad® to control it

### Reciprocating and continuous motions

### Calibration function (CAL) for more precise torque setting

### Sensitive touch ON/OFF button

### Auto-reverse rotation at preset torque limit (in both motions)

\*Speed = 300rpm and torque = 2Ncm

### Lithium-ion battery

- Autonomy for 16 treatments\*
- Full recharge in 6 hours
- Automatic sleep mode and auto-power off
- Motor handpiece is rechargeable during treatment
- Torque range:** 0.5Ncm – 5Ncm (depending on maximum speed)
- Speed range:** 250rpm – 850rpm
- Contra-angle head autoclavable at 134°C
- Universal charger (100-240V, 50 Hz / 60 Hz)

\*A treatment is defined as 2 canals with 4 files per canal used for 30s each

## DENTSPLY iQ APPLICATION

- Includes file library with preset programs for WAVEONE GOLD, WAVEONE, PROTAPER NEXT, PROTAPER UNIVERSAL, PROFILE, PATHFILE and PROGLIDER files
- Customisable file library and compatible with other shaping systems
- Can control 2 handpieces for 4-hand technique
- Possibility to set-up multiple users
- Compatible with iOS® 8

## iPAD MINI™ PROTECTIVE CASE

- Dimensions**
  - Landscape 209x140x86mm
  - Portrait 144x125x196mm
- Optimal results with nitrile gloves (non-latex preferred)
- Compatible with iPad Mini™ 1, 2 and 3
- Water-resistant (IP 30)

# PRODUCT REFERENCES

X-smart iQ™	X-smart iQ™	X-smart iQ™	X-smart iQ™
ENDODONTIC HANDPIECE SET	BASIC STARTER KIT	wave•one <sup>®</sup> GOLD STARTER KIT	PROTAPER•NEXT <sup>®</sup> STARTER KIT
A10548000000	A10540000000	A10541000000	A10542000000
<b>Set contains:</b> <ul style="list-style-type: none"> <li>X-SMART iQ Motor Handpiece</li> <li>X-SMART iQ Contra-angle</li> </ul>	<b>Kit contains:</b> <ul style="list-style-type: none"> <li>X-SMART iQ Motor Handpiece</li> <li>X-SMART iQ Contra-angle</li> <li>X-SMART iQ iPad Mini™ Protective Case</li> </ul>	<b>Kit contains:</b> <ul style="list-style-type: none"> <li>X-SMART iQ Motor Handpiece</li> <li>X-SMART iQ Contra-angle</li> <li>X-SMART iQ iPad Mini™ Protective Case</li> <li>5 blisters WAVEONE GOLD Primary, 25mm (15 files)</li> <li>4 blisters WAVEONE GOLD Assortment, 25mm (16 files)</li> <li>1 blister PROGLIDER, 25mm (3 files)</li> </ul>	<b>Kit contains:</b> <ul style="list-style-type: none"> <li>X-SMART iQ Motor Handpiece</li> <li>X-SMART iQ Contra-angle</li> <li>X-SMART iQ iPad Mini™ Protective Case</li> <li>10 blisters PROTAPER NEXT Assortment X1-X3, 25mm (30 files)</li> <li>1 blister PROGLIDER, 25mm (3 files)</li> </ul>

## Spare Parts

A10510000000  
A10580000000  
A10522000000

- X-SMART iQ Contra-angle
- X-SMART iQ Handpiece Sleeves
- X-SMART iQ iPad Mini™ Protective Case

A10530000000  
A10582000000  
A10581000000  
A10521000000

- X-SMART iQ Universal Charger
- X-SMART iQ Contra-angle Cleaning Adapter
- X-SMART iQ Spray Adapter
- X-SMART iQ Handpiece Support and Case

# DENTSPLY

Small things. Big difference

CONTACT US:

0800 072 3313  
dentsply.co.uk



Apple, iPad and iPad Mini are trademarks of Apple Inc., registered in the U.S. and other countries. App Store is a service mark of Apple Inc. iOS is a trademark or registered trademark of Cisco in the U.S. and other countries and is used under licence. The Bluetooth® word mark and logos are registered trademarks owned by Bluetooth SIG, Inc. and any use of such marks by DENTSPLY is under licence.

THE MAKERS OF

PROTAPER® | CAVITRON® | WAVEONE® | SDR® | CERAM.X® | NUPRO®